

# Crosby® Bolt Type Shackles



## G-2130 / S-2130

Bolt Type Anchor shackles with thin head bolt - nut with cotter pin. Meets the performance requirements of Federal Specification RR-C-271F Type IVA, Grade A, Class 3, except for those provisions required of the contractor. For additional information, see page 452.

- Capacities 1/3 thru 150 metric tons, grade 6.
- Working Load Limit and grade "6" permanently shown on every shackle.
- Forged – Quenched and Tempered, with alloy pins.
- Hot Dip galvanized or self colored. (85, 120, and 150 metric ton shackles are all hot dip galvanized bows and the bolts are Dimetcoated® and painted red)
- Fatigue rated (1/3t - 55t).
- Shackles 25t and larger are **RFID EQUIPPED**.
- Approved for use at -40 degree C (-40 degree F) to 204 degree C (400 degree F).
- Meets or exceeds all requirements of ASME B30.26.
- Shackles 85 metric tons and larger are individually proof tested to 2.0 times the working load limit.
- Type Approval and certification in accordance with ABS 2011 Steel Vessel Rules 1-1-17.7, and ABS Guide for Certification of Cranes.
- 3.1 Certification as standard available for charpy and statistical proof test for pg 79 only up to 25 tons to DNV2.7-1 and EN13889.
- Crosby 3.25t through 25t G2130OC anchor shackles are type approved to DNV Certification Notes 2.7-1- Offshore Containers. These Crosby shackles are statistical proof and impact tested to 42 joules (31 ft.-lbs.) min. avg. at -20 degrees C (-4 degrees F). The tests are conducted by Crosby and 3.1 test certification is available upon request. Refer to page 88 for Crosby COLD TUFF® shackles that meet the additional requirements of DNV rules for certification of lifting applications - Loose Gear.
- All other 2130 shackles can meet charpy requirements of 42 joules (31 ft.-lbs) avg at -20 degrees C (-4 degrees F) upon special request.
- Look for the Red Pin® . . . the mark of genuine Crosby quality.

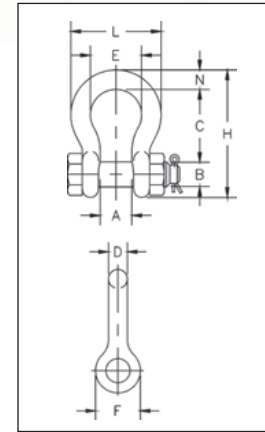

**SEE APPLICATION INFORMATION**  
On Page 92 of the General Catalog  
Para Español: www.thecrosbygroup.com

## G-2130 / S-2130 Bolt Type Anchor Shackles

Nominal Size (in.)	Working Load Limit (t)*	Stock No.			Weight Each (kg)	Dimensions (mm)										Tolerance +/-	
		G-2130	S-2130	G-2130OC		A	B	C	D	E	F	H	L	N	C	A	
3/16	1/3 ‡	1019464	–	–	.03	9.65	6.35	22.4	4.85	15.2	14.2	37.3	24.9	4.85	1.50	1.50	
1/4	1/2	1019466	–	–	.05	11.9	7.85	28.7	6.35	19.8	15.5	46.7	32.5	6.35	1.50	1.50	
5/16	3/4	1019468	–	–	.10	13.5	9.65	31.0	7.85	21.3	19.1	53.0	37.3	7.85	1.50	1.50	
3/8	1	1019470	–	–	.15	16.8	11.2	36.6	9.65	26.2	23.1	63.0	45.2	9.65	3.30	1.50	
7/16	1-1/2	1019471	–	–	.22	19.1	12.7	42.9	11.2	29.5	26.9	74.0	51.5	11.2	3.30	1.50	
1/2	2	1019472	1019481	–	.36	20.6	16.0	47.8	12.7	33.3	30.2	83.5	58.5	12.7	3.30	1.50	
5/8	3-1/4	1019490	1019506	1262013	.62	26.9	19.1	60.5	16.0	42.9	38.1	106	74.5	17.5	3.30	1.50	
3/4	4-3/4	1019515	1019524	1262022	1.23	31.8	22.4	71.5	19.1	51.0	46.0	126	89.0	20.6	6.35	1.50	
7/8	6-1/2	1019533	1019542	1262031	1.79	36.6	25.4	84.0	22.4	58.0	53.0	148	102	24.6	6.35	1.50	
1	8-1/2	1019551	1019560	1262040	2.28	42.9	28.7	95.5	25.4	68.5	60.5	167	119	26.9	6.35	1.50	
1-1/8	9-1/2	1019579	1019588	1262059	3.75	46.0	31.8	108	28.7	74.0	68.5	190	131	31.8	6.35	1.50	
1-1/4	12	1019597	1019604	1262068	5.31	51.5	35.1	119	31.8	82.5	76.0	210	146	35.1	6.35	1.50	
1-3/8	13-1/2	1019613	1019622	1262077	7.18	57.0	38.1	133	35.1	92.0	84.0	233	162	38.1	6.35	3.30	
1-1/2	17	1019631	1019640	1262086	8.62	60.5	41.4	146	38.1	98.5	92.0	254	175	41.1	6.35	3.30	
1-3/4	25	1019659	1019668	1262095	15.4	73.0	51.0	178	44.5	127	106	313	225	57.0	6.35	3.30	
2	35	1019677	1019686	–	23.7	82.5	57.0	197	51.0	146	122	348	253	61.0	6.35	3.30	
2-1/2	55	1019695	1019702	–	44.6	105	70.0	267	66.5	184	145	453	327	79.5	6.35	6.35	
3	† 85	1019711	–	–	70	127	82.5	330	76.0	200	165	546	365	92.0	6.35	6.35	
3-1/2	† 120 ‡	1019739	–	–	120	133	95.5	372	92.0	229	203	626	419	105	6.35	6.35	
4	† 150 ‡	1019757	–	–	153	140	108	368	104	254	229	653	468	116	6.35	6.35	

\* NOTE: Maximum Proof Load is 2.0 times the Working Load Limit. Minimum Ultimate Strength is 6 times the Working Load Limit. For Working Load Limit reduction due to side loading applications, see page 94. † Individually Proof Tested with certification. ‡ Furnished in Anchor style only and furnished with Round Head Bolts with welded handles.

**SHACKLES**