

Crosby® Lifting Clamps



CROSBY[®] LIFTING CLAMPS

Vertical Clamps



IPU10

The IPU10 vertical lifting clamp is used for lifting, turning, moving or vertical transfer of sheet, plates, or fabrications from horizontal to vertical and down to horizontal (180°) as needed. The hinged hoisting eye allows for the clamp to place and lift the load from any direction, or with a multiple leg sling without side-loading the clamp.

Universal - For Lifting in any Direction

- Available in capacities of .5 thru 30 metric tons (Higher Working Load Limits are available upon request).
- Wide variety of jaw openings available: 0° to 155mm.
- Welded alloy steel body for strength and smaller size. Forged alloy components, where required.
- Individually Proof Tested to 2 times the Working Load Limit with certification.
- Company name (CrosbyIP), logo, Working Load Limit and jaw opening permanently stamped on body.
- Each product is individually serialized, with the serial number and Proof Load test date stamped on body. User manual with test certificate is included with each clamp.
- Available in a variety of styles:
 - IP10 - Standard clamp for materials with a surface hardness to 363HV10 (345 HB).
 - IP10J - Larger jaw opening.
 - IP10S - For use with Stainless Steel material.
 - IP10H - For use with materials with a surface hardness to 472HV10 (450 HB).
- Full 180° turning range for material transfer, turning or moving.
- Lock open, lock closed ability with latch for pretension on material and then release of material.
- Optional IP-5000 Stinger assembly available (see page 428). Allows for easy connection between the clamp and hoist hook.
- Minimum WLL of 10% of Maximum WLL.
- Maintenance replacement kits are available.
- Manufactured by an ISO 9001 facility.
- All sizes are **RFID EQUIPPED**.



IPU10S

IPU10S: For use with Stainless Steel material.
IPU10H: For use with materials with a surface hardness to 47Rc (450 HB).



Load Rated

Model IPU10 / IPU10S / IPU10H

Model	Working Load Limit (t)*	IPU10 Stock No.	Weight Each (kg.)	Dimensions (mm)									
				Jaw A	B	C	D	E	F	G	H	J	K
IPU10	0.5	2701675	1.9	0 - 16	44	128	228	40	115	41	28	-	11
IPU10	1	2701663	2.4	0 - 20	45	139	222	40	126	41	38	-	11
IPU10	2	2701677	8.5	0 - 35	78	201	372	70	190	61	55	-	16
IPU10	3	2701665	14.8	0 - 40	100	253	445	75	225	78	60	-	20
IPU10	4.5	2701667	16.0	0 - 40	100	253	445	75	232	82	65	-	20
IPU10	6	2701669	24.0	0 - 50	126	302	525	80	292	84	95	44	20
IPU10J	6	2702469	30.5	50 - 100	126	302	525	80	342	84	95	44	20
IPU10	9	2701671	29.5	0 - 50	126	325	557	80	310	92	105	44	20
IPU10J	9	2701673	30.5	50 - 100	126	325	562	80	360	92	105	44	20
IPU10	12	2701679	57.0	0 - 54	160	391	623	80	331	117	137	41	25
IPU10J	12	2701681	59.0	54 - 108	178	439	673	80	415	117	137	41	25
IPU10	16	2701683	72.0	5 - 64	178	465	734	88	397	119	153	45	25
IPU10J	16	2701685	85.0	64 - 128	208	521	790	88	472	119	161	45	25
IPU10	22.5	2701687	127	5 - 80	222	554	855	110	470	136	186	49	25
IPU10J	22.5	2701689	130	80 - 155	253	628	930	110	575	136	196	49	25
IPU10	30	2701691	153	5 - 80	222	545	860	110	470	152	186	54	30
IPU10J	30	2701693	165	80 - 155	250	620	935	110	565	152	196	54	30
For stainless steel - with universal hoisting eye													
IPU10S	0.5	2702275	1.9	0 - 16	44	128	228	40	115	41	28	-	11
IPU10S	1	2702263	2.1	0 - 20	45	139	222	40	126	41	38	-	11
IPU10S	2	2702277	7.6	0 - 35	78	201	372	70	190	61	55	-	16
IPU10S	3	2702265	14.8	0 - 40	100	253	445	75	225	78	60	-	20
IPU10S	4.5	2702267	16.0	0 - 40	100	253	445	75	232	82	65	-	20
IPU10S	6	2702269	24.0	0 - 50	126	302	525	80	292	84	95	44	20
IPU10S	9	2702271	29.5	0 - 50	126	325	557	80	310	92	105	44	20
IPU10S	12	2702279	30.5	0 - 54	160	391	623	80	331	117	137	41	25
For very hard materials - with universal hoisting eye													
IPU10H	0.5	2702175	1.9	0 - 16	44	128	228	40	115	41	28	-	11
IPU10H	1	2702177	7.6	0 - 35	78	201	372	70	190	61	55	-	16
IPU10H	2	2702165	14.8	0 - 40	100	253	445	75	225	78	60	-	20
IPU10H	3	2702167	16.0	0 - 40	100	253	445	75	232	82	65	-	20
IPU10H	4.5	2702169	24.0	0 - 50	126	302	525	80	292	84	95	44	20
IPU10/H	6	2702171	29.5	0 - 50	126	325	557	80	310	92	105	44	20

* Design Factor based on EN 13155 and ASME B30.20. Model IP10R (remote control opening and closing via a cable) on request. Model IPU10W (wedge) available on request.

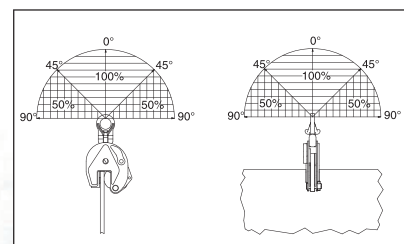
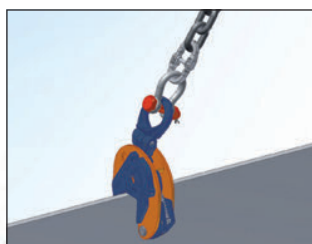
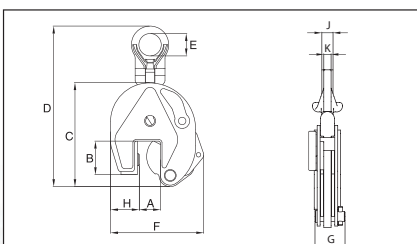

Vertical Clamps



IP10

The IP10 vertical lifting clamp is used for the lifting, turning, moving or vertical transfer of sheet, plates, or fabrications from horizontal to vertical and down to horizontal (180°) as needed. Usually used as a single point pick or when used with a spreader beam with multiple vertical drop lines.

For Vertical Lifting, Turning and Transfer

- Available in capacities of .5 thru 30 metric tons (Higher Working Load Limits are available upon request).
- Wide variety of jaw openings available: 0 to 155mm.
- Welded alloy steel body for strength and smaller size. Forged alloy components, where required.
- Individually Proof Tested to 2 times the Working Load Limit with certification.
- Company name (CrosbyIP), logo, Working Load Limit and jaw opening permanently stamped on body.
- Each product is individually serialized, with the serial number and Proof Load test date stamped on body. Serial number is included on the test certificate with maintenance and warranty logbook.
- Available in a variety of styles:
 - IP10 - Standard clamp for materials with a surface hardness to 363HV10 (345 HB).
 - IP10J - Larger jaw opening.
 - IP10S - For use with Stainless Steel material.
 - IP10H - For use with materials with a surface hardness to 472HV10 (450 HB).
- Full 180° turning range for material transfer, turning or moving.
- Lock open, lock closed ability with latch for pretension on material and then release of material.
- Optional IP-5000 Stinger assembly available (see page 428). Allows for easy connection between the clamp and hoist hook.
- Minimum WLL of 10% of Maximum WLL.
- Maintenance replacement kits are available.
- Manufactured by an ISO 9001 facility.
- All sizes are **RFID EQUIPPED**

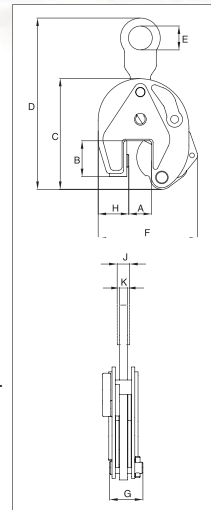

Model IP10

Model	Working Load Limit (t)*	IP10 Stock No.	Weight Each (kg)	Dimensions (mm)									
				Jaw A	B	C	D	E	F	G	H	J	K
IP10	0.5	2701674	1.8	0 - 16	44	128	207	30	115	41	28	-	10
IP10	1	2701662	2.2	0 - 20	45	139	215	30	126	41	38	-	10
IP10	2	2701676	7.6	0 - 35	78	201	336	70	190	61	55	-	16
IP10	3	2701664	13.8	0 - 40	100	253	436	75	225	78	60	-	20
IP10	4.5	2701666	15.0	0 - 40	100	253	436	75	232	82	65	-	20
IP10	6	2701668	23.5	0 - 50	126	302	515	80	292	84	95	40	20
IP10J	6	2701705	28.5	50 - 100	126	302	515	80	342	84	95	40	20
IP10	9	2701670	27.5	0 - 50	126	325	550	80	310	92	105	44	25
IP10J	9	2701672	28.5	50 - 100	126	325	555	80	360	92	105	44	25
IP10	12	2701678	49.0	0 - 54	160	391	580	80	331	117	137	41	25
IP10J	12	2701680	58.0	54 - 108	178	439	630	80	415	117	137	41	25
IP10	16	2701682	68.0	5 - 64	178	465	690	88	397	119	153	49	25
IP10J	16	2701684	90.0	64 - 128	208	521	746	88	472	119	161	49	25
IP10	22.5	2701686	108	5 - 80	222	554	800	110	470	136	186	49	25
IP10J	22.5	2701688	110	80 - 155	253	628	880	110	575	136	196	49	25
IP10	30	2701690	148	5 - 80	222	545	800	110	470	152	186	54	30
IP10J	30	2701692	152	80 - 155	250	620	880	110	565	152	196	54	30
For stainless steel - with fixed hoisting eye													
IP10S	0.5	2702274	1.8	0 - 16	44	128	207	30	115	41	28	-	10
IP10S	1	2702262	2.0	0 - 20	45	139	215	30	126	41	38	-	10
IP10S	2	2702276	6.8	0 - 35	78	201	336	70	190	61	55	-	16
IP10S	3	2702264	13.8	0 - 40	100	253	436	75	225	78	60	-	20
IP10S	4.5	2702266	15.0	0 - 40	100	253	436	75	232	82	65	-	20
IP10S	6	2702268	23.5	0 - 50	126	302	525	80	292	84	95	40	20
IP10S	9	2702270	27.5	0 - 50	126	325	557	80	310	92	105	44	25
IP10S	12	2702278	49.0	0 - 54	160	391	623	80	331	117	137	41	25
For very hard materials - with fixed hoisting eye													
IP10H	0.5	2702174	1.8	0 - 16	44	128	207	30	115	41	28	-	10
IP10H	1	2702176	6.8	0 - 35	78	201	336	70	190	61	55	-	10
IP10H	2	2702164	13.8	0 - 40	100	253	436	75	225	78	60	-	16
IP10H	3	2702166	15.0	0 - 40	100	253	436	75	232	82	65	-	20
IP10H	4.5	2702168	23.5	0 - 50	126	302	515	80	292	84	95	40	20
IP10H	6	2702170	27.5	0 - 50	126	325	550	80	310	92	105	44	25

* Design Factor based on EN 13155 and ASME B30.20. Model IP10R (remote control opening and closing via a cable) on request. Not for USA.

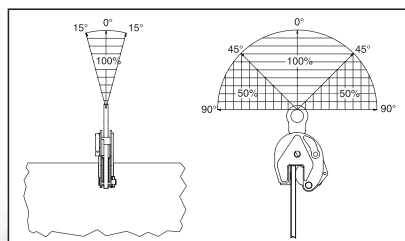

Vertical Clamps



IPNM10N

The IPNM10N vertical lifting clamp is used for lifting, turning, moving or vertical transfer of sheet, plates, or fabrications from horizontal to vertical and down to horizontal (180°) as needed without marring the surface of the material. Materials such as aluminum, stainless steel, painted materials, aircraft skins, composite material, glass, plastic, etc., can be lifted without marring.

Will NOT mar, or scratch the material surface.

For use in almost all sectors of industry where during the lift or transfer, no damage to the material is permitted.

- Available in capacities of .5 , 1 and 2 metric tons.
- Wide variety of jaw openings available: 0 to 40mm.
- Welded alloy steel body for strength and smaller size. Forged alloy components, where required.
- Individually Proof Tested to 2 times the Working Load Limit with certification.
- Company name (CrosbyIP), logo, Working Load Limit and jaw opening permanently stamped on body.
- Each product is individually serialized, with the serial number and Proof Load test date stamped on body. User manual with test certificate is included with each clamp.
- Full 180° turning range for material transfer, turning or moving.
- Lock open, lock closed ability with latch for pretension on material and then release of material.
- Optional IP-5000 Stinger assembly available (see page 428). Allows for easy connection between the clamp and hoist hook.
- Material must be clean and dry.
- Maintenance replacement kits are available.
- Manufactured by an ISO 9001 facility.
- All sizes are **RFID EQUIPPED**.



IPNM10P

The IPNM10P vertical lifting clamp is used for lifting, turning, moving or vertical transfer of sheet, plates, or fabrications from horizontal to vertical and down to horizontal (180°) as needed without marring the surface of the material. Materials such as aluminum, stainless steel, painted materials, aircraft skins, composite material, glass, plastic, etc., can be lifted without marring. The protective cover reduces the risk of damage to surrounding plates.

Will NOT mar, or scratch the material surface.



Load Rated

Model IPNM10

Model	Working Load Limit (t)*	IPNM10 Stock No.	Weight Each (kg)	Dimensions (mm)								
				Jaw A	B	C	D	E	F	G	H	K
IPNM10N	.5	2703811	2.7	0 - 10	84	159	235	40	128	60	41	11
IPNM10N	1	2703738	4.4	0 - 20	110	209	270	30	134	80	56	10
IPNM10	2	2703442	14.5	0 - 40	153	258	396	70	196	100	16	16
With protection cap												
IPNM10P	.5	2703278	2.8	0 - 10	82	157	213	40	145	68	48	11
IPNM10P	1	2703279	4.5	0 - 20	97	195	268	30	205	82	60	10
With larger jaw opening												
IPNM10NJ	1	2703814	5.5	20 - 37	86	196	265	30	177	80	51	10

* Design Factor based on EN 13155 and ASME B30.20.

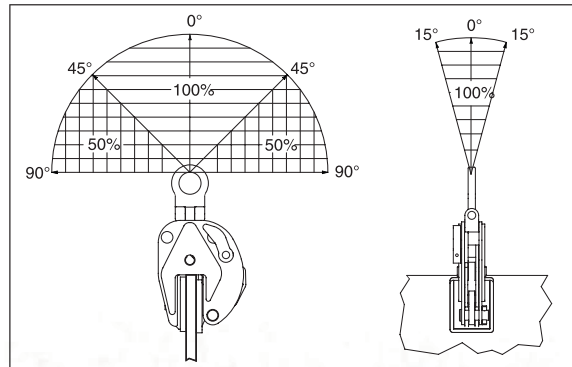
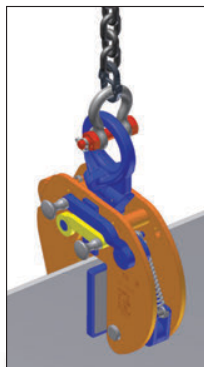
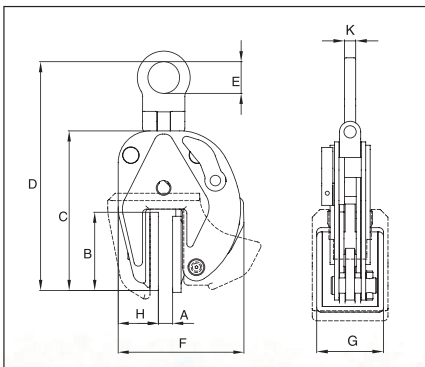

Vertical Clamps



IPU10/A

The IPU10/A automatically clicks on to the material as soon as the clamp is placed on the plate. The fact that the safety lock remains in position as the clamp closes precludes hazardous situations. Fastening the IPU10/A clamp in places that are difficult to reach is no problem.

For vertical transport of plates

- Available in capacities of 1 and 2 metric tons.
- Jaw openings available: 0 to 35mm.
- Welded alloy steel body for strength and smaller size. Forged alloy components where required.
- Individually Proof Tested to 2 times the Working Load Limit with certification.
- Company name (CrosbyIP), logo, Working Load Limit and jaw opening permanently stamped on body.
- Each product is individually serialized, with the serial number and Proof Load test date stamped on body. User manual with test certificate is included with each clamp.
- Full 180° turning range for material transfer, turning or moving.
- Lock open, lock ability with latch for pretension on material and then release of material.
- Optional IP-5000 Stinger assembly available (see page 428). Allows for easy connection between the clamp and hoist hook.
- Minimum WLL of 10% of Maximum WLL.
- Maintenance replacement parts are available.
- Manufactured by an ISO 9001 facility.
- All sizes are **RFID EQUIPPED**.

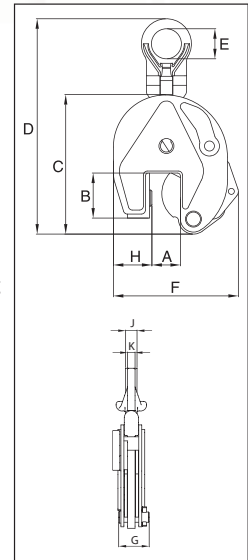

Load Rated

Model IPU10/A

Model	Working Load Limit (t)*	IPU10/A Stock No.	Weight Each (kg)	Dimensions (mm)								
				Jaw A	B	C	D	E	F	G	H	K
IPU10/A	1	2701628	2.3	0 - 20	45	138	238	40	128	41	37	11
IPU10/A	2	2701629	8.9	0 - 35	78	201	378	70	200	61	72	16

* Design Factor based on EN 13155 and ASME B30.20.

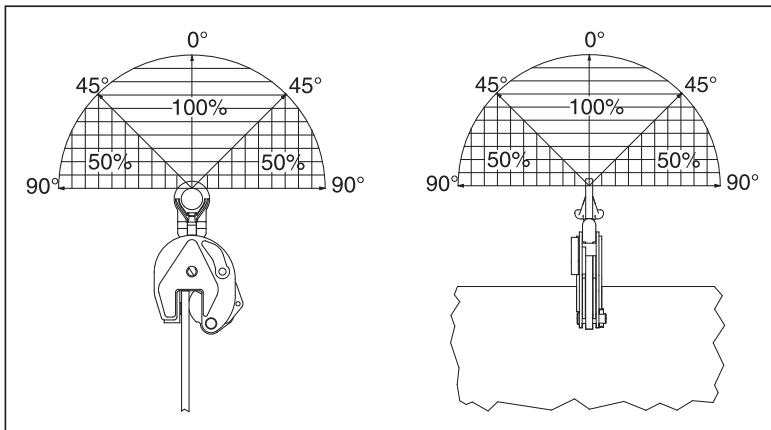

CROSBY® LIFTING CLAMPS

Beam Clamps



IPBKZ

The IPBKZ beam clamp is used for lifting, transfer ring and stacking H-Beams. An over-center hoist eye allows for the beam flange to remain vertical. This series of clamps can be used in vertical and horizontal moving, transfer ring and stacking of different types of structural designs, such as H-Beams, angles, etc, depending on the application desired.

For the Transfer and Stacking of Steel Beams

- Available in capacities of .75 thru 3.75 metric tons.
- Wide variety of jaw openings available: 0 to 28mm.
- Welded alloy steel body for strength and smaller size. Forged alloy components, where required.
- Individually Proof Tested to 2 times the Working Load Limit with certification.
- Company name (CrosbyIP), logo, Working Load Limit and jaw opening permanently stamped on body.
- Each product is individually serialized, with the serial number and Proof Load test date stamped on body. User manual with test certificate is included with each clamp.
- Optional IP-5000 Stinger assembly available (see page 428). Allows for easy connection between the clamp and hoist hook.
- Minimum WLL of 10% of Maximum WLL.
- Maintenance replacement parts are available.
- Manufactured by a ISO 9001 facility.
- All sizes are **RFID EQUIPPED**.



IPVUZ

The IPVZ / IPVUZ beam clamp is used for vertical lift and transfer of angle iron and other loads that have only a small gripping area for the clamp ("U" has universal hoisting eye).

This series of clamps can be used in vertical and horizontal moving, transfer ring and stacking of different types of structural designs, such as H-beams, angles, etc, depending on the application desired.



Model IPBKZ

Model	Working Load Limit (t)*	IPBKZ Stock No.	Weight Each (kg)	Dimensions (mm)								
				Jaw A	B	C	D	E	F	G	H	J
IPBKZ	.75	2705780	3.5	5 - 15	43	132	192	45	113	47	38	10
IPBKZ	1.5	2705781	7.0	5 - 25	62	210	300	70	163	61	50	16
IPBKZ	3.75	2705782	15.5	5 - 28	75	260	415	100	202	78	52	20

* Design Factor based on EN 13155 and ASME B30.20.

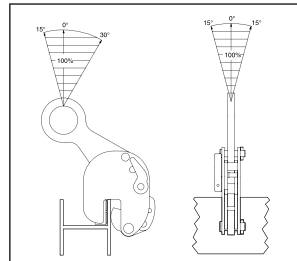
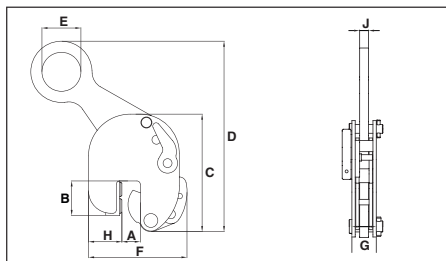

Model IPVUZ: Universal Hoisting Eye / Model IPVZ: Fixed Hoisting Eye

Model	Working Load Limit (t)*	Stock No.	Weight Each (kg)	Dimensions (mm)								
				Jaw A	B	C	D	E	F	G	H	K
IPVUZ	0.75	2705146	2.3	0 - 15	26	128	238	30	128	41	37	10
IPVUZ	1.5	2705147	8.9	0 - 20	60	200	378	70	200	61	72	16
Fixed Hoisting Eye												
IPVZ	0.75	2705096	2.1	0 - 15	26	128	207	30	115	41	30	10
IPVZ	1.5	2705097	6.2	0 - 20	60	200	339	70	180	52	50	16

* Design Factor based on EN 13155 and ASME B30.20.

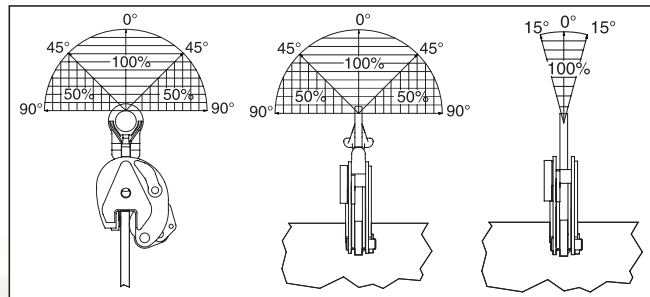
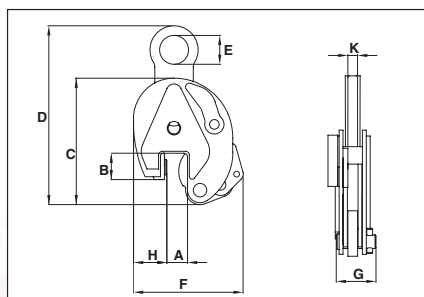

Shipbuilding Clamps: Bulb Profiles



IPBUZ

The IPBUZ shipbuilding clamps are used for lifting, transfer ring and placing bulb profiles onto ship's hulls perpendicularly. These clamps are fitted with a locking device for both open and closed positions, which ensures complete reliability. They are to be used exclusively for bulb profiles (not for plates).

For lifting, transfer ring and placing Bulb Profiles onto Ships' Hulls Perpendicularly

- Available in capacities of .75 thru 3.75 metric tons.
- Jaw openings available: HP 120mm to HP 430mm.
- Welded alloy steel body for strength and smaller size. Forged alloy components, where required.
- Individually Proof Tested to 2 times the Working Load Limit with certification.
- Company name (CrosbyIP), logo, Working Load Limit and jaw opening permanently stamped on body.
- Each product is individually serialized, with the serial number and Proof Load test date stamped on body. User manual with test certificate is included with each clamp.
- Optional IP-5000 Stinger assembly available (see page 428). Allows for easy connection between the clamp and hoist hook.
- Maintenance replacement parts are available.
- Manufactured by a ISO 9001 facility.
- All sizes are **RFID EQUIPPED**.

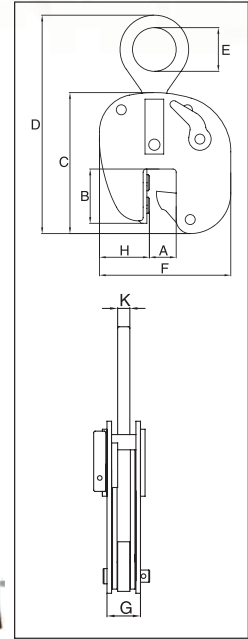

Model IPBUUZ: with Universal Hoisting Eye Model IPBUZ: with Fixed Hoisting Eye

Model	Working Load Limit (t)*	Stock No.	Weight Each (kg)	Dimensions (mm)								
				Profile A †	B	C	D	E	F	G	H	K
IPBUUZ	.75	2705601	8.5	HP 120-200	85	226	390	70	210	61	70	16
With fixed hoisting eye												
IPBUZ	.75	2705600	7.0	HP 120-200	85	226	390	70	210	61	70	16
IPBUZ	1.5	2705701	15.0	HP 220-430	196	397	568	70	256	69	48	16
IPBUZ	3.75	2705702	28.5	HP 220-430	238	438	565	80	355	64	100	20

* Design Factor based on EN 13155 and ASME B30.20. † Profile A is the type of Holland Bulb (HP) style and size material.

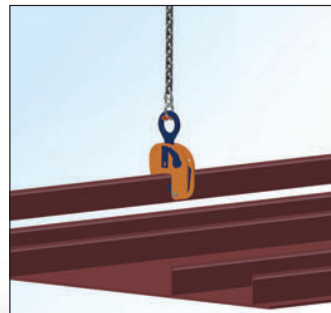
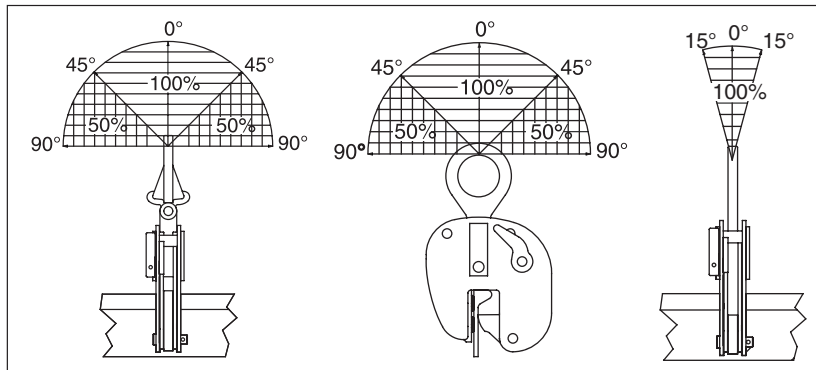

Shipbuilding Clamps: Ship Sections



IPSBUUZ

The IPSBU(U)Z shipbuilding clamps are used for the lifting, transfer and placing of complete shipsections. These clamps are fitted with a locking device for both open and closed positions, which ensures complete reliability. They are to be used exclusively for bulb profiles (not for plates).

For lifting, transfer ring and placing complete shipsections

- Available in capacities of 4.5 thru 22.50 metric tons.
- Wide variety of jaw openings available: HP 100mm to HP 430mm.
- Welded alloy steel body for strength and smaller size. Forged alloy components, where required.
- Individually Proof Tested to 2 times the Working Load Limit with certification.
- Company name (CrosbyIP), logo, Working Load Limit and jaw opening permanently stamped on body.
- Each product is individually serialized, with the serial number and Proof Load test date stamped on body. User manual with test certificate is included with each clamp.
- Optional IP-5000 Stinger assembly available (see page 428). Allows for easy connection between the clamp and hoist hook.
- Maintenance replacement parts are available.
- Manufactured by a ISO 9001 facility.
- All sizes are **RFID EQUIPPED**.

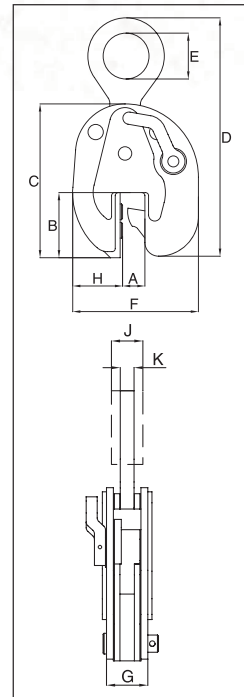

Model IPSBUUZ and IPSBUSUZ: With Universal Hoisting Eye Model IPSBUZ and IPSBUSZ: With Fixed Hoisting Eye

Model	Working Load Limit (t)*	Stock No.	Weight Each (kg)	Dimensions (mm)									
				Profile A†	B	C	D	E	F	G	H	J	K
IPSBUUZ	4.5	2705771	15.5	HP 100-160	107	252	450	75	206	96	82	36	20
IPSBUSUZ	4.5	2705772	38.0	HP 180-430	227	428	635	75	377	95	128	-	20
IPSBUUZ	9	2705773	43.0	HP 100-160	105	274	491	80	248	123	104	44	20
IPSBUSUZ	9	2705774	59.0	HP 180-430	227	478	718	80	425	118	155	44	25
With fixed hoisting eye													
IPSBUZ	4.5	2705721	13.5	HP 100-160	107	252	382	75	206	96	82	-	20
IPSBUSZ	4.5	2705722	35.8	HP 180-430	227	428	592	75	377	95	128	-	20
IPSBUZ	9	2705723	23.0	HP 100-160	105	274	461	80	248	123	104	-	30
IPSBUSZ	9	2705724	68.0	HP 180-430	227	478	672	80	425	118	155	45	25
IPSBUSZ	15	2705728	64.0	HP 180-430	226	485	690	88	401	100	135	49	25
IPSBUSZ	22.5	2705730	100	HP 180-430	224	543	740	90	470	116	185	-	30

* Design Factor based on EN 13155 and ASME B30.20. † Profile A is the type of Holland Bulb (HP) style and size material.

