

Crosby® Lifting Clamps



# CROSBY<sup>®</sup> LIFTING CLAMPS

## Beam Clamps



**IPBHZ**

The IPBHZ beam clamp is used for horizontal lifting and transfer ring of steel beams. The base is slotted to allow the clamps to be used from end of beams as well as from the flange. This series of clamps can be used in vertical and horizontal moving, transfer ring and stacking of different types of structural designs, such as I-Beams, H-beams, angles, etc, depending on the application desired.

### For the Lifting and Transfer of Steel Beams

- Available in capacities of .75 thru 12 metric tons.
- Wide variety of jaw openings available: 0 to 50mm.
- Welded alloy steel body for strength and smaller size. Forged alloy components, where required.
- Individually Proof Tested to 2 times the Working Load Limit with certification.
- Company name (CrosbyIP), logo, Working Load Limit and jaw opening permanently stamped on body.
- Each product is individually serialized, with the serial number and Proof Load test date stamped on body. User manual with test certificate is included with each clamp.
- Optional IP-5000 Stinger assembly available (see page 428). Allows for easy connection between the clamp and hoist hook.
- Minimum WLL of 10% of Maximum WLL.
- Maintenance replacement parts are available.
- Manufactured by a ISO 9001 facility.
- All sizes are **RFID EQUIPPED**.



**IPBSNZ**

The IPBSNZ beam clamp is used for lifting, transfer ring and stacking. Offset hoisting eye allows for level lifts of I-Beams. Also for lifting fabrications and ship sections. This series of clamps can be used in vertical and horizontal moving, transfer ring and stacking of different types of structural designs, such as I-Beams, depending on the application desired.



### Model IPBHZ

Model	Working Load Limit (t)*	IPBHZ Stock No.	Weight Each (kg)	Dimensions (mm)								
				Jaw A	B	C	D	E	F	G	J	K
IPBHZ	.75	2705461	3.0	0 - 25	40	148	220	50	130	69	33	22
IPBHZ	1.5	2705462	6.0	0 - 25	60	200	255	50	153	73	35	28
IPBHZ	3	2705463	10.5	0 - 40	80	227	325	70	188	112	38	32
IPBHZ	4.5	2705464	25.0	0 - 40	112	284	413	70	251	116	80	40
IPBHZ	12	2705467	42.0	0 - 40	125	466	490	90	317	90	90	47

\* Design Factor based on EN 13155 and ASME B30.20.

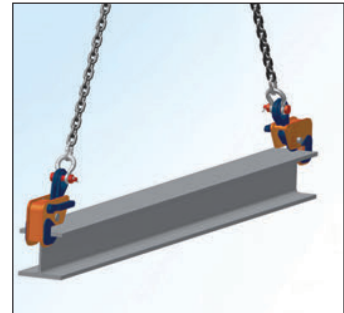
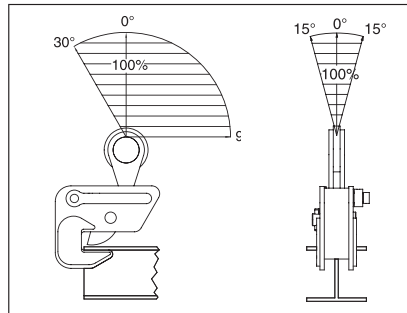
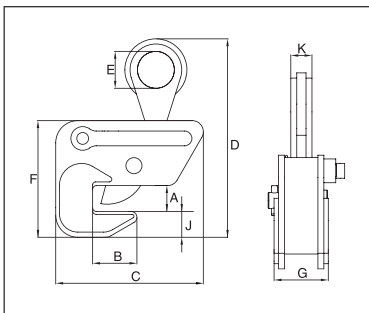

### Model IPBSNZ

Model	Working Load Limit (t)*	IPBSNZ Stock No.	Weight Each (kg)	Dimensions (mm)									
				Jaw A	B	C	D	E	F	G	H	J	K
IPBSNZ	1.5	2705925	14.0	0 - 32	100 - 270	304	480	70	319	47	16	165	148
IPBSNZ	3	2705926	22.0	0 - 40	100 - 330	352	494	75	408	56	20	207	182
IPBSNZ	4.5	2705927	30.5	0 - 50	100 - 360	420	630	75	457	56	20	250	188

\* Design Factor based on EN 13155 and ASME B30.20.

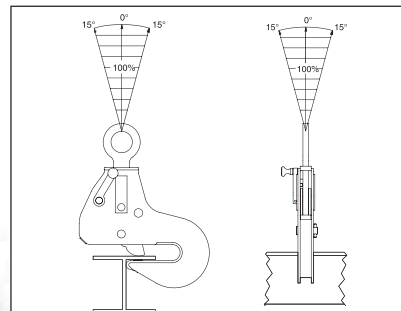
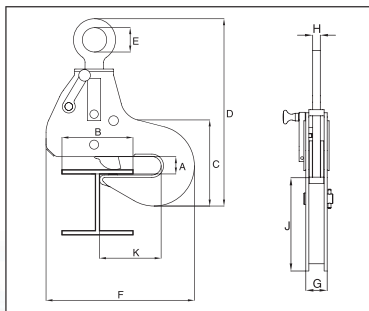

# Beam Clamps



### IPTK

This IPTK series beam clamp is suitable for use as a temporary tackle eye for a beam.

## For transfer ring steel beams and attaching tackle eye

- Available in capacities of 2 thru 25 metric tons.
- Wide variety of jaw openings available: 75 to 1020mm.
- Welded alloy steel body for strength and smaller size. Forged alloy components, where required.
- Individually Proof Tested to 2 times the Working Load Limit with certification.
- Company name (CrosbyIP), logo, Working Load Limit and jaw opening permanently stamped on body.
- Each product is individually serialized, with the serial number and Proof Load test date stamped on body. User manual with test certificate is included with each clamp.
- Maintenance replacement parts are available.
- Manufactured by a ISO 9001 facility.
- All sizes are RFID EQUIPPED.

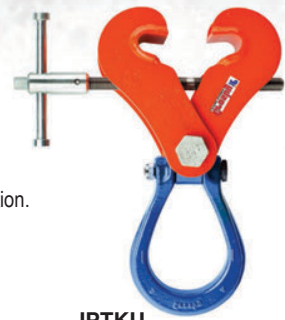

### IPTKU

This IPTKU series beam clamp has an improved hinged hoisting eye that increases the loading angles and an optional new "Double Locking Device".



### IPTKW

This IPTKW series beam clamp is suitable for use as a temporary tackle eye for a beam.

- Model IPTK: With Hoisting Eye
- Model IPTKW: Without Hoisting Eye
- Model IPTKU: With Hinged Hoisting Eye
- Model IPTKUD: With Double Locking Device



Load Rated

Model	Working Load Limit (t)*	Stock No.	Weight Each (kg)	Dimensions (mm)							
				Jaw A	C	D	E	F	H	J	K
IPTK	2	2700996	6.0	75 - 190	A + 80	125	75	-	25	-	20
IPTK	3	2700997	6.5	75 - 190	A + 80	125	75	-	25	-	20
IPTK	4	2700998	8.5	150 - 280	A + 100	125	75	-	35	-	20
IPTK	5	2700994	11.0	120 - 350	A + 195	125	75	-	40	-	20
IPTK	10	2700970	31.0	300 - 500	A + 300	171	74	-	40	-	30
IPTK	25	2702999	225	450 - 1020	A + 220	500	125	-	76	-	45
<b>Without Hoisting Eye</b>											
IPTKW	2	2700966	4.0	75 - 190	A + 80	125	-	28	25	-	-
IPTKW	3	2700967	4.5	75 - 190	A + 80	125	-	28	25	-	-
IPTKW	4	2700968	6.3	150 - 280	A + 100	125	-	33	35	-	-
IPTKW	5	2700969	8.8	120 - 350	A + 195	125	-	33	40	-	-
<b>With Improved Hinged Hoisting Eye</b>											
IPTKU	2	2707996	5.8	75 - 190	A + 100	121	76	-	22	99	19
IPTKU	3	2707997	6.5	75 - 190	A + 100	121	89	-	22	122	22
IPTKU	4	2707998	9.9	120 - 280	A + 150	140	89	-	40	122	22
IPTKU	5	2707994	12.0	120 - 350	A + 175	140	89	-	40	122	22
IPTKU	10	2707970	38.0	200 - 460	A + 300	200	105	-	60	152	26
<b>With Optional Double Locking Device</b>											
IPTKU/D	2	2709996	5.8	75 - 190	A + 100	165	89	-	22	99	19
IPTKU/D	3	2709993	6.5	75 - 190	A + 100	165	89	-	22	122	22
IPTKU/D	4	2709995	9.9	120 - 280	A + 150	185	89	-	40	122	22
IPTKU/D	5	2709994	12.0	120 - 350	A + 175	185	89	-	40	122	22
IPTKU/D	10	2709970	38.0	200 - 460	A + 300	250	105	-	60	152	26

\* Design Factor based on EN 13155 and ASME B30.20.

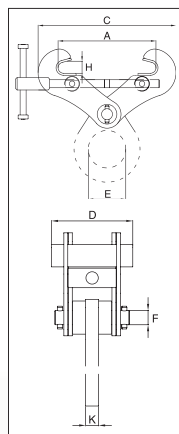

IPTK

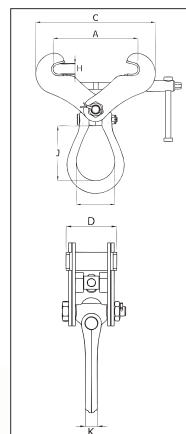

IPTKU

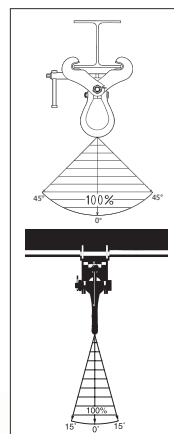

IPTKU

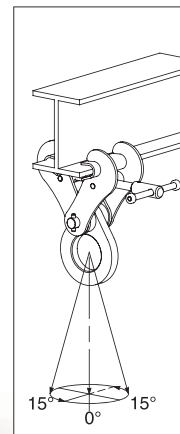

IPTKW

Beam Clamps



**For lifting and transfer ring steel beams**

- Available in capacities of 1.5 and 2.5 metric tons.
- Jaw openings available: 6 to 20mm.
- Welded alloy steel body for strength and smaller size. Forged alloy components, where required.
- Individually Proof Tested to 2 times the Working Load Limit with certification.
- Company name (Crosby/IP), logo, Working Load Limit and jaw opening permanently stamped on body.
- Each product is individually serialized, with the serial number and Proof Load test date stamped on body. User manual with test certificate is included with each clamp.
- Maintenance replacement parts are available.
- Manufactured by an ISO 9001 facility.
- All sizes are **RFID EQUIPPED**.

**IPSTARTEC11**

The IPSTARTEC11 beam clamp has been specially developed for lifting with the body in vertical position, controlled tilting, transportation and stacking of steel "H" and "I" profiles. By placing the chain guide in the appropriate position, it is easy to switch from lifting to tilting and back again, which shifts the center of gravity.

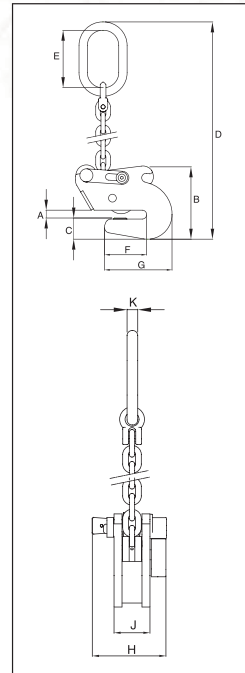

Model IPSTARTEC11

Model	Working Load Limit (t)*	IPSTARTEC11 Stock No.	Weight Each (kg)	Dimensions (mm)									
				Jaw A	B	C	D	E	F	G	H	J	K
IPSTARTEC11	1.5	2701812	6.6	6 - 12	140	39	575	110	81	129	54	126	16
IPSTARTEC11	2.5	2701822	14.5	6 - 20	210	55	725	135	115	182	74	140	18

\* Design Factor based on EN 13155 and ASME B30.20.

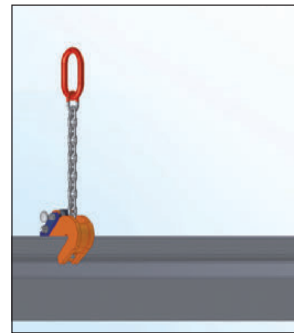
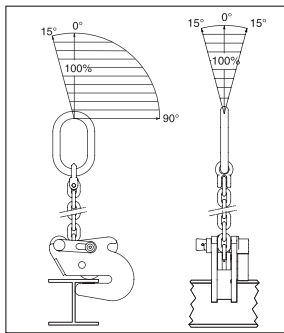

# Drum Clamps



**IPDV**  
The IPDV drum clamp is for vertical lift and transfer. Allows drum to remain in an upright position during the lift and transfer using one clamp.

## Designed to lift, move and transfer 50-55 gallon drums with steel tops

- Available in capacity of .5 metric tons.
- Jaw openings available: IPDV - 300mm IPVK - 17mm.
- Welded alloy steel body for strength and smaller size. Forged alloy components, where required.
- Individually Proof Tested to 2 times the Working Load Limit with certification.
- Company name (CrosbyIP), logo, Working Load Limit and jaw opening permanently stamped on body.
- Each product is individually serialized, with the serial number and Proof Load test date stamped on body. User manual with test certificate is included with each clamp.
- Maintenance replacement parts are available.
- Manufactured by an ISO 9001 facility.
- IPDV is **RFID EQUIPPED**.

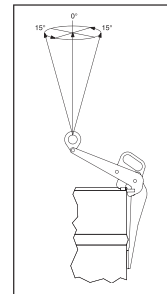
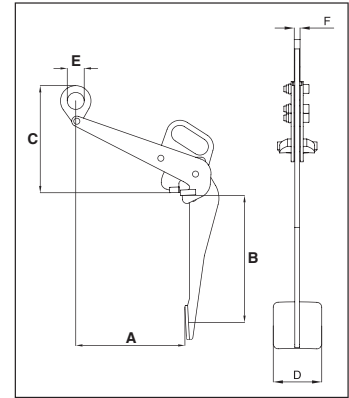

### Model IPDV

Model	Working Load Limit (t)*	IPDV Stock No.	Weight Each (kg)	Dimensions (mm)					
				Jaw A	B	C	D	E	F
IPDV	.5	2700118	7.1	300	375	290	150	50	12

\* Design Factor based on EN 13155 and ASME B30.20.



**IPVK**  
The IPVK drum clamp is for vertical lift and transfer. Automatically locks on drum, and can be used alone or in pairs.

### Model IPVK

Model	Working Load Limit (t)*	IPVK Stock No.	Weight Each (kg)	Dimensions (mm)						
				Jaw A	B	C	D	E	G	K
IPVK	.5	2700116	1.6	17	26	26	132	29	51	11

\* Design Factor based on EN 13155 and ASME B30.20.

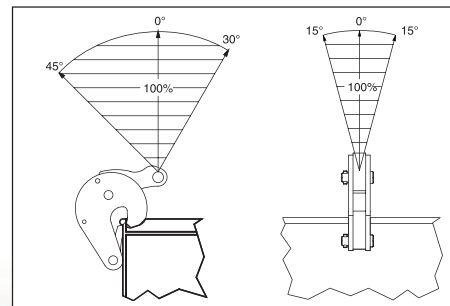
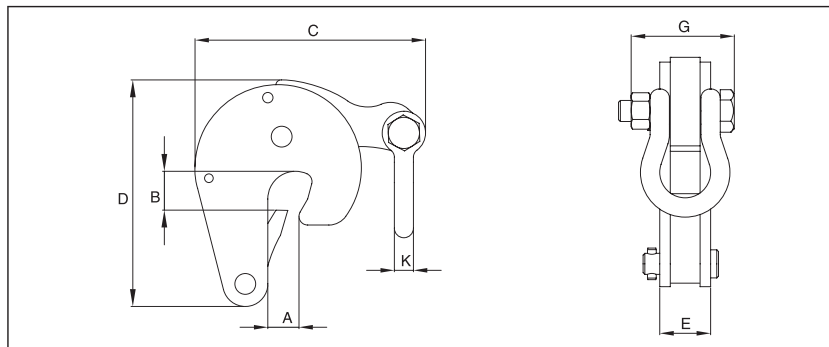

Vertical Clamps



IPCC

The IPCC is suitable for the vertical lifting and transfer of concrete pipe sections and wells. Very easy application and removal of the clamp thanks to the built-in carrying-grips. Normally used in combination with 7mm chain (not supplied). These clamps must be used in pairs or more.

**For lifting and transfer ring of concrete pipe sections and wells**

- Available in capacity of 1 metric tons.
- Jaw opening available: 40 - 140mm.
- Welded alloy steel body for strength and smaller size. Forged alloy components, where required.
- Individually Proof Tested to 2 times the Working Load Limit with certification.
- Company name (Crosby/IP), logo, Working Load Limit and jaw opening permanently stamped on body.
- Each product is individually serialized, with the serial number and Proof Load test date stamped on body. User manual with test certificate is included with each clamp.
- Maintenance and replacement parts are available.
- Manufactured by an ISO 9001 facility.
- All sizes are **RFID EQUIPPED**.

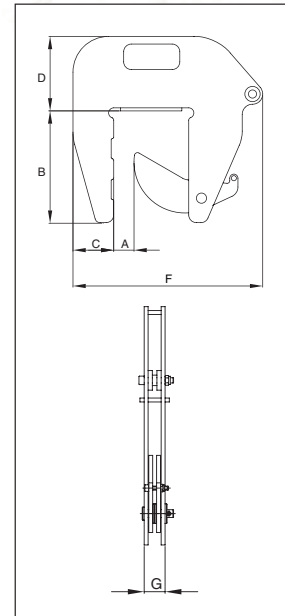

Load Rated

Model IPCC

Model	IPCC Stock No.	Working Load Limit Per Pair (t)*	Weight Each (kg)	Dimensions (mm)									
				Jaw A	B	C	D	E	F	G	H	J	K
IPCC	2700037	1,0	9.2	40-140	225	80	146	-	372	37	-	-	-

\* Design Factor based on EN 13155 and ASME B30.20.

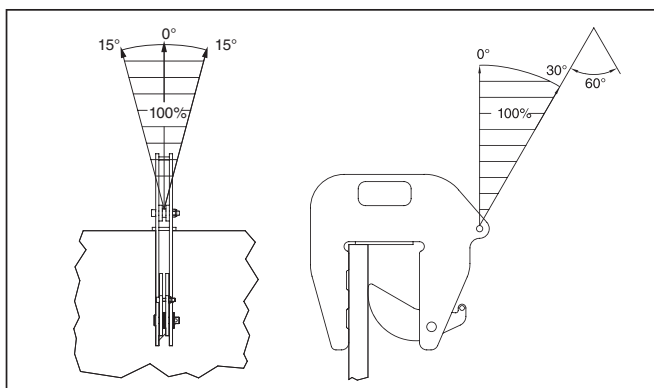

# Shipbuilding Clamps: Bulb Profiles



**D K O -**

The IPBTO10 shipbuilding clamp is used as a temporary tackle eye in spaces which have been reinforced with HP (bulb) profiles such as engine rooms and shipsections. This clamp is fitted with a screwed spindle for easy attachment of the clamp. The moment a load is applied, the clamp is automatically fixed.

- Available in capacities of 1.5 thru 6 metric tons.
- Wide variety of jaw openings available: HP 160mm to HP 430mm.
- Welded alloy steel body for strength and smaller size. Forged alloy components, where required.
- Individually Proof Tested to 2 times the Working Load Limit with certification.
- Company name (CrosbyIP), logo, Working Load Limit and jaw opening permanently stamped on body.
- Each product is individually serialized, with the serial number and Proof Load test date stamped on body. User manual with test certificate is included with each clamp.
- Maintenance replacement parts are available.
- Manufactured by an ISO 9001 facility.

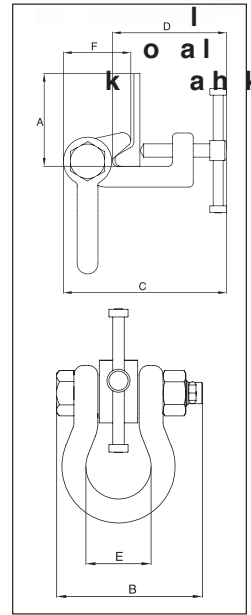

**H g d - D K O**

H g	R <sub>d</sub> g c a f l	G D K O G N l g c	a a a l g c	a e f k a g f k					
				K g a d	w	e e			
IPBTO10	1.5	2700980	4.3	HP 160-240	137	188-209	129-150	68	81
IPBTO10	3	2700986	6.0	HP 240-320	137	188-217	145-174	68	78
IPBTO10	6	2700991	13.0	HP 300-430	185	255-297	195-236	98	102

\* Design Factor based on EN 13155 and ASME B30.20. wProfile A is the type of Holland Bulb (HP) style and size material.

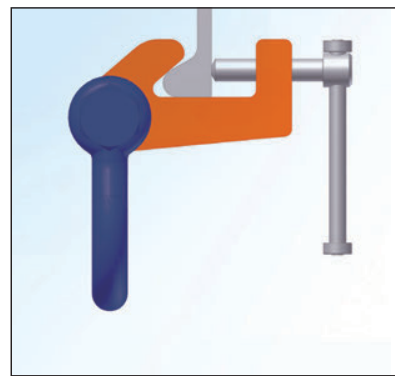
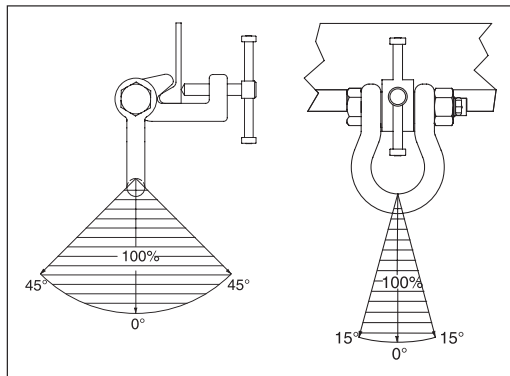

**CROSBY® LIFTING CLAMPS**



**IPSC10**

The IPSC10 screw style clamp is for positioning, pulling and turning plates or fabrications.

**Suitable for use in positioning & turning steel plates and sections.  
Not to be used as a lifting clamp.**

- Available in capacities of 1.5 and 3 metric tons.
- Jaw openings available: 0 to 60mm.
- Suitable for steel with a surface hardness up to 30 Rc.
- Forged alloy steel body for strength and smaller size. Forged alloy components, where required.
- Individually Proof Tested to 2 times the Working Load Limit with certification.
- Company name (CrosbyIP), logo, Working Load Limit and jaw opening permanently stamped on body.
- Each product is individually serialized, with the serial number and Proof Load test date stamped on body. User manual with test certificate is included with each clamp.
- Maintenance replacement parts are available.
- Manufactured by an ISO 9001 facility.



**Load Rated**

**Model IPSC10**

Model	Working Load Limit (t)*	IPSC Stock No.	Weight Each (kg)	Dimensions (mm)									
				Jaw A	B	C	D	E	F	G	H	J	K
IPSC10	1.5	2703857	4.6	0 - 40	90	143	251	44	156	50	45	16	65
IPSC10	3	2703858	8.4	0 - 60	109	175	310	51	200	62	55	19	83

\* Design Factor based on EN 13155 and ASME B30.20.

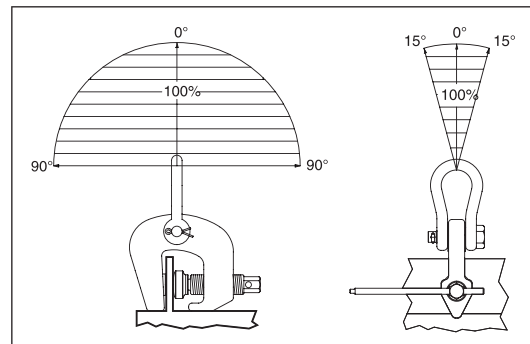
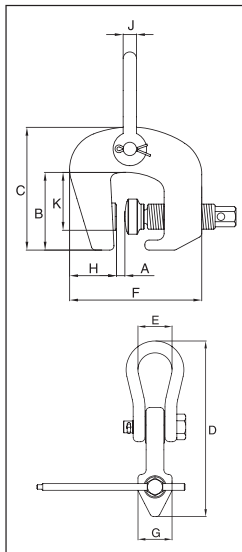

**IP5000**

The IP5000 Stinger Assembly is designed to be used as a connecting link between the clamp and the hoist hook.

**Provides easy attachment of selected Crosby® IP clamp to hoist hook.**

- Available in three sizes for the IP10 and IPU10 with capacities from .5 to 12 metric tons.
- Assembly consists of welded alloy master link, Grade 80 chain and A-1337 Lok-A-Loy for attachment to the clamp hoisting eye.
- Individually Proof Tested to 2.5 times the Working Load Limit of Grade 80 chain with certification.
- Company name or logo and frame number permanently stamped on link.
- Locking system provides for simple assembly - no special tools needed.
- Finish - Red Paint.
- Manufactured by an ISO 9001 facility.



**NOTE: Not Intended to be Used as a Chain Sling.**

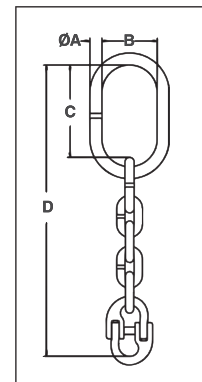

**Model IP5000**

Frame Size	Chain Size		Crosby® IP10 and IPU10 Clamp Sizes (t)*	IP5000 Stock No.	Weight Each (kg)	Dimensions (mm)			
	(in.)	(mm)				A	B	C	D
1	5/16	8	0.5 - 1	2701695	.95	13.0	59.9	100	315
2	1/2	13	2 - 4.5	2701704	3.4	22.1	89.9	144	484
3	7/8	22	6 - 12	2701713	14.7	36.1	140	234	820

\* The working load of the assembly is based on working load limit of the selected clamp. Ultimate load is 5 times the Working Load Limit.